

■ Replacement Parts List

Notes: * Important safety notice:

Components identified by Δ mark have special characteristics important for safety.

Furthermore, special parts which have purposes of fire-retardant (resistors), high-quality sound (capacitors), low-noise (resistors), etc. are used.

When replacing any of components, be sure to use only manufacturer's specified parts shown in the parts list.

* The parenthesized indications in the Remarks columns specify the areas. (Refer to the cover page for area.) Parts without these indications can be used for all areas.

* Capacity values are in microfarads (μF) unless specified otherwise, P=Pico-farads (pF) F=Farads (F)

* Resistance values are in ohms, unless specified otherwise, 1K=1,000 (OHM), 1M=1,000k (OHM)

Ref.No.	Part No.	Part Name & Description	Pcs	Remarks
1	RGK0817-1M	SIDE PANEL (L)	1	
2	RGK0818-1M	SIDE PANEL (R)	1	
3	RHD30073-K	SCREW	4	
4	RKA0076-N	FOOT	4	
5	XTB3+8JFZ	SCREW	1	
6	REZ0883	FFC (14P)	1	
7	REZ0944	FFC (23P)	1	
8	XTB3+12JFZ	SCREW	4	
9	XTBS3+8JFZ1	SCREW	10	
10	SHE170-2	P. C. B. SUPPORT	4	
11	RGU1394A-S	BUTTON	1	
12	RMND195	FL HOLD PIECE	2	
13	XTBS26+8J	SCREW	9	
14	RFKGTHD81E-N	FRONT PANEL ASS'Y	1	
15	RGK0819-N3	SIDE ORNEMENT (L)	1	
16	RGK0820-N3	SIDE ORNAMENT (R)	1	
C101	ECBT1C103NS5	16V 0.01U	1	
C103	ECBT1C103NS5	16V 0.01U	1	
C104, 05	ECBT1H102KB5	50V 1000P	2	
C106	ECBT1C103NS5	16V 0.01U	1	
C107	ECBT1H473ZF5	50V 0.047U	1	
C108	ECBT1H8R2KC5	50V 8.2P	1	
C109, 10	ECBT1C103NS5	16V 0.01U	2	
C111	ECEA1EKA4R7B	25V 4.7U	1	
C112	ECBT1C103NS5	16V 0.01U	1	
C113	ECBT1H102KB5	50V 1000P	1	
C114	RCE1HKA3R3BG	50V 3.3U	1	
C115	ECEA1EKA4R7B	25V 4.7U	1	
C116	ECBT1C822KS5	16V 8200P	1	
C117	ECQP1391JZ3	100V 390P	1	
C118, 19	ECFR1C103KR	16V 0.01U	2	
C120, 21	ECEA1HKA010B	50V 1U	2	
C122	ECEA1HKA2R2B	50V 2.2U	1	
C123	ECEA1HKA010B	50V 1U	1	
C124	ECBT1H102KB5	50V 1000P	1	
C125	ECBT1H150JCS	50V 15P	1	
C126	ECBT1H473ZF5	50V 0.047U	1	
C127	ECEA1CKA220B	16V 22U	1	
C128	ECBT1H102KB5	50V 1000P	1	
C129, 30	ECEA0JKA101B	6.3V 100U	2	
C132	ECBT1H102KB5	50V 1000P	1	
C133, 34	ECBT1H270JU5	50V 27P	2	

Ref.No.	Part No.	Part Name & Description	Pcs	Remarks
C135, 36	ECBT1C103KS5	16V 0.01U	2	
C137, 38	ECBT1H561KB5	50V 560P	2	
C139, 40	ECBT1C682KR5	16V 6800P	2	
C141-44	ECEA1HKA010B	50V 1U	4	
C145	ECBT1H220JCS	50V 22P	1	
C148	ECBT1C103NS5	16V 0.01U	1	
C149	ECBT1H104ZF5	50V 0.1U	1	
C171, 72	ECBT1H102KB5	50V 1000P	2	
C173	ECEA1CKA220B	16V 22U	1	
C174	RCE1CKA100BG	16V 10U	1	
C181	ECBT1H471KB5	50V 470P	1	
C196	ECBT1H102KB5	50V 1000P	1	
C205-08	ECBT1H101KB5	50V 100P	4	
C209, 10	ECBT1H180J5	50V 18P	2	
C211	ECBT1H102KB5	50V 1000P	1	
C223, 24	ECBT1H104ZF5	50V 0.1U	2	
C225-27	ECBT1H470J5	50V 47P	3	
C231, 32	ECBT1E103ZF5	25V 0.01U	2	
C233, 34	ECBT1H102KB5	50V 1000P	2	
C235, 36	ECBT1H101KB5	50V 100P	2	
C237, 38	ECBT1H470J5	50V 47P	2	
C321, 22	ECBT1E103ZF5	25V 0.01U	2	
C323, 24	ECBT1H102KB5	50V 1000P	2	
C325, 26	ECBT1H101KB5	50V 100P	2	
C327, 28	RCE1AKA470BG	10V 47U	2	
C333, 34	ECBT1H221KB5	50V 220P	2	
C335, 36	RCE1CKA100BG	16V 10U	2	
C337, 38	ECEA1CKA220B	16V 22U	2	
C339, 40	RCE1CKA100BG	16V 10U	2	
C341, 42	ECEA1AKN100B	10V 10U	2	
C343	RCE1CKA100BG	16V 10U	1	
C344, 45	ECBT1H470J5	50V 47P	2	
C348	ECEA1CKA330B	16V 33U	1	
C350	ECEA0JKA470B	6.3V 47U	1	
C351, 52	RCE1CKA100BG	16V 10U	2	
C355	ECEA1CKA330B	16V 33U	1	
C356	ECBT1H104ZF5	50V 0.1U	1	
C357	RCE1AKA101BG	10V 100U	1	
C365	ECEA0JKA470B	6.3V 47U	1	
C391, 92	ECEA1CKA101B	16V 100U	2	
C393, 94	ECBT1H102KB5	50V 1000P	2	
C501	ECEA1EKA101B	25V 100U	1	
C502	ECA1VM101B	35V 100U	1	
C503	ECBT1E103ZF5	25V 0.01U	1	
C504	ECEA1EKA101B	25V 100U	1	
C509	ECBT1E103ZF5	25V 0.01U	1	
C510	RCE1AKA101BG	10V 100U	1	
C513-15	ECBT1H102KB5	50V 1000P	3	
C550, 51	ECA0JKF101B	6.3V 100U	2	
C557	ECBT1H102KB5	50V 1000P	1	
C558	ECEA0JKA101B	6.3V 100U	1	
C559, 60	ECEA1HKA010B	50V 1U	2	
C570	ECBT1H102KB5	50V 1000P	1	
C601, 02	ECKR1H223ZF5	50V 0.022U	2	
Δ C603	ECA1EM102B	25V 1000U	1	
Δ C604	RCE1EM471BV	25V 470U	1	
C605, 06	ECBT1E103ZF5	25V 0.01U	2	
C607, 08	RCE1AKA470BG	10V 47U	2	
C609	ECBT1H102KB5	50V 1000P	1	
C610, 11	ECBT1H104ZF5	50V 0.1U	2	
C612	RCE1EM471BV	25V 470U	1	
C613	ECBT1E103ZF5	25V 0.01U	1	
C614	RCE1AKA470BG	10V 47U	1	
C615	ECEA1EKA101B	25V 100U	1	
Δ C616	ECA1HM470B	50V 47U	1	
Δ C618	ECA2AM470B	100V 47U	1	
C619	ECKR1H103ZF5	50V 0.01U	1	
C620	RCE1WKA100BG	35V 10U	1	
C623	RCE1AKA101BG	10V 100U	1	
C624	ECEA1VKA470B	35V 47U	1	
C631-36	ECBT1H101KB5	50V 100P	6	
C651, 52	ECBT1H104ZF5	50V 0.1U	2	
C655	ECQV1H224JM3	50V 0.22U	1	
C656	ECQV1H474JM3	50V 0.47U	1	
C901-04	ECBT1H471KB5	50V 470P	4	

Ref.No.	Part No.	Part Name & Description	Pcs	Remarks
C905, 06	ECBT1H102KB5	50V 100P	2	
C907	ECBT1H104ZF5	50V 0.1U	1	
C908	ECBT1E103ZF5	25V 0.01U	1	
C909	ECEA1HKA2R2B	50V 2.2U	1	
C910	RCE1CKA100BG	16V 10U	1	
C911	ECBT1H270JU5	50V 27P	1	
C912	ECBT1H220CC5	50V 22P	1	
C913	ECEA1VKA470B	35V 47U	1	
C915	ECBT1E103ZF5	25V 0.01U	1	
C916, 17	ECEA1HKA010B	50V 1U	2	
C918	ECBT1C105ZF5	16V 1U	1	
C919	RCE0JU102BV	6.3V 1000U	1	
C920	ECBT1E103ZF5	25V 0.01U	1	
C922	ECEA0JKA221B	6.3V 220U	1	
C923	ECBT1H101KB5	50V 100P	1	
C924	ECBT1H102KB5	50V 1000P	1	
C954-57	ECBT1H101KB5	50V 100P	4	
CF201	RLFFETNGD01L	CERAMIC FILTER	1	
CF202	RLFFETMGD01L	CERAMIC FILTER	1	
CN101A	RJT057W007-1	CONNECTOR (7P)	1	
CN101B	RJU057W007	SOCKET (7P)	1	
CN102A	RJT057W007-1	CONNECTOR (7P)	1	
CN102B	RJU057W007	SOCKET (7P)	1	
CN103A	RJT057W007-1	CONNECTOR (7P)	1	
CN103B	RJU057W007	SOCKET (7P)	1	
CN104A	RJT057W007-1	CONNECTOR (7P)	1	
CN104B, 05	RJU057W007	SOCKET (7P)	2	
CN502A	RJT057W007-1	CONNECTOR (7P)	1	
CN502B	RJU057W007	SOCKET (7P)	1	
CN901A	RJS1A6823	CONNECTOR (23P)	1	
CN901B	RJS1A6223-1	CONNECTOR (23P)	1	
CN902A	RJS1A6814	CONNECTOR (14P)	1	
CN902B	RJS1A6214-1	CONNECTOR (14P)	1	
CN904A	RJT066H05A	CONNECTOR (5P)	1	
CN904B	RJU066H05	SOCKET (5P)	1	
CP105	RJT057W007-1	CONNECTOR (7P)	1	
△ D101	MA4051MTA	DIODE	1	
D102	MA165	DIODE	1	
D301	MA165	DIODE	1	
△ D501, 02	MA185TA	DIODE	2	
△ D503	MA4150MTA	DIODE	1	
△ D504	MA4082LTA	DIODE	1	
D550, 51	MA165	DIODE	2	
D552	MA723TA	DIODE	1	
△ D601-04	RL1N4003N02	DIODE	4	
D605	MA165	DIODE	1	
D606, 07	MA719TA	DIODE	2	
△ D609, 10	MA4082LTA	DIODE	2	
△ D611, 12	RL1N4003N02	DIODE	2	
△ D613, 14	MA185TA	DIODE	2	
△ D615	MA4051MTA	DIODE	1	
△ D616	MA4062-H	DIODE	1	
△ D617	MA4300MTA	DIODE	1	
△ D618-21	RL1N4003N02	DIODE	4	
△ D622	MA4039MTA	DIODE	1	
D632	MA165	DIODE	1	
D651, 52	MA165	DIODE	2	
D653	MA719TA	DIODE	1	
D901, 02	MA165	DIODE	2	
D910	1SS291TA	DIODE	1	
D911	MA165	DIODE	1	
D912	1SS291TA	DIODE	1	
D936	MA165	DIODE	1	
D938, 39	MA165	DIODE	2	
D960	MA165	DIODE	1	
D963, 64	MA165	DIODE	2	
FL901	RSL0225-F	DISPLAY TUBE	1	
IC101	LA1832WH-TEL	IC	1	
IC102	LC7218M-TE-L	IC	1	

Ref.No.	Part No.	Part Name & Description	Pcs	Remarks
IC202	NJU7313AMT2	IC	1	
IC203	M5219FPFTA	IC	1	
IC204	M5218AFPE3	IC	1	
IC302	M62425FPE1	IC	1	
IC551	STK311-010	IC	1	
IC552	LC6510AA4F75	IC	1	
IC901	M38198MCO92F	IC	1	
JK101	RJH5210M	FM/AM ANT	1	
JK202	SJF3069-5N	EXT IN/OUT	1	
JK601	RJT065K15	CONNECTOR (15P)	1	
JK602	RJT065K19	CONNECTOR (19P)	1	
JK603	RJT065K20	CONNECTOR (20P)	1	
L101	ELESNR68MA	COIL	1	
L103	ELEXR47MA9	COIL	1	
L104	ELEXT1R0KA9	COIL	1	
L105, 06	ELELN822KL	COIL	2	
L151	SMLB10M-1M	COIL	1	
L191	ELESNR68MA	COIL	1	
L550	ELEXT101KA9	COIL	1	
L552	ELEXT101KA9	COIL	1	
L601	ELEXT1R0KA9	COIL	1	
L901	RLQA100JT-Y	COIL	1	
L902	ELEXT1R0KA9	COIL	1	
Q101, 02	2SC2787L	TRANSISTOR	2	
Q103, 04	2SC2785FETA	TRANSISTOR	2	
Q106	UN4111	TRANSISTOR	1	
Q107, 08	2SC3311ARSTA	TRANSISTOR	2	
Q110	2SC3311ARSTA	TRANSISTOR	1	
Q309, 10	2SA1309ATA	TRANSISTOR	2	
Q311, 12	2SC3311AR	TRANSISTOR	2	
Q316	UN4115TA	TRANSISTOR	1	
Q317, 18	2SC3311AR	TRANSISTOR	2	
Q319	UN4115TA	TRANSISTOR	1	
△ Q501	2SC3940AQSTA	TRANSISTOR	1	
△ Q503	2SC3940AQSTA	TRANSISTOR	1	
Q550, 51	UN4211TA	TRANSISTOR	2	
Q552	UN411FTA	TRANSISTOR	1	
Q553	UN4211TA	TRANSISTOR	1	
△ Q601	2SD2137PQTA	TRANSISTOR	1	
△ Q602	2SB1417PQTA	TRANSISTOR	1	
Q604	2SD2144STA	TRANSISTOR	1	
△ Q605	2SD2137PQTA	TRANSISTOR	1	
△ Q606	2SB621AQRSTA	TRANSISTOR	1	
Q901	UN4214TA	TRANSISTOR	1	
Q902	DTC143XSTP	TRANSISTOR	1	
Q903, 04	2SC3311AR	TRANSISTOR	2	
R103	ERDS2FJ101	1/4W 100	1	
R104	ERDS2FJ103	1/4W 10K	1	
R105	ERDS2TJ471T	1/4W 470	1	
R106	ERDS2FJ474	1/4W 470K	1	
R107	ERDS2TJ331T	1/4W 330	1	
R108	ERDS2FJ474	1/4W 470K	1	
R109	ERDS2TJ331T	1/4W 330	1	
R110	ERDS2FJ102	1/4W 1K	1	
R112	ERDS2FJ104	1/4W 100K	1	
R113	ERDS2FJ103	1/4W 10K	1	
R114	ERDS2FJ562	1/4W 5.6K	1	
R115	ERDS2TJ561T	1/4W 560	1	
R116	ERDS2FJ102	1/4W 1K	1	
R117	ERDS2FJ823	1/4W 82K	1	
R118	ERDS2FJ472	1/4W 4.7K	1	
R119	ERDS2FJ103	1/4W 10K	1	
R120	ERDS2TJ473T	1/4W 47K	1	
R121	ERDS2TJ332T	1/4W 3.3K	1	
R122	ERDS2FJ272	1/4W 2.7K	1	
R124	ERDS2TJ271T	1/4W 270	1	
R125, 26	ERDS2TJ152T	1/4W 1.5K	2	
R127	ERDS2FJ103	1/4W 10K	1	
R128	ERDS2TJ820T	1/4W 82	1	
R129	ERDS2TJ473T	1/4W 47K	1	
R130	ERDS2FJ103	1/4W 10K	1	

Ref. No.	Part No.	Part Name & Description	Pcs	Remarks	Ref. No.	Part No.	Part Name & Description	Pcs	Remarks
R132	ERDS2FJ103	1/4W 10K	1		R623, 24	ERDS2FJ224	1/4W 220K	2	
R133-37	ERDS2FJ102	1/4W 1K	5		R627-30	ERDS2FJ472	1/4W 4.7K	4	
R138	ERDS2FJ103	1/4W 10K	1		R631, 32	ERDS2TJ471T	1/4W 470	2	
R139, 40	ERDS2FJ272	1/4W 2.7K	2		R635, 36	ERDS2FJ472	1/4W 4.7K	2	
R141, 42	ERDS2FJ102	1/4W 1K	2		R637, 38	ERDS2FJ150	1/4W 15	2	
R143, 44	ERDS2FJ222	1/4W 2.2K	2		R641, 42	ERDS2TJ471T	1/4W 470	2	
R145, 46	ERDS2TJ821T	1/4W 820	2		R656	ERDS2TJ221T	1/4W 220	1	
R147, 48	ERDS2FJ474	1/4W 470K	2		R901	ERDS2TJ821T	1/4W 820	1	
R149	ERDS2FJ680	1/4W 68	1		R902	ERDS2FJ102	1/4W 1K	1	
R171, 72	ERDS2FJ102	1/4W 1K	2		R903	ERDS2TJ122T	1/4W 1.2K	1	
R173	ERDS2TJ471T	1/4W 470	1		R904	ERDS2TJ152T	1/4W 1.5K	1	
R175	ERDS2FJ102	1/4W 1K	1		R905	ERDS2TJ182T	1/4W 1.8K	1	
R176	ERDS2TJ391T	1/4W 390	1		R906	ERDS2FJ222	1/4W 2.2K	1	
R177	ERDS2FJ472	1/4W 4.7K	1		R907	ERDS2TJ332T	1/4W 3.3K	1	
R205, 06	ERDS2FJ224	1/4W 220K	2		R908	ERDS2FJ472	1/4W 4.7K	1	
R207, 08	ERDS2FJ102	1/4W 1K	2		R909	ERDS2FJ682	1/4W 6.8K	1	
R209-12	ERDS2TJ822T	1/4W 8.2K	4		R911	ERDS2TJ473T	1/4W 47K	1	
R225, 26	ERDS2TJ122T	1/4W 1.2K	2		R916-19	ERDS2FJ103	1/4W 10K	4	
R229-31	ERDS2FJ222	1/4W 2.2K	3		R920-22	ERDS2FJ102	1/4W 1K	3	
R233, 34	ERDS2TJ223T	1/4W 22K	2		R923	ERDS2TJ391T	1/4W 390	1	
R235, 36	ERDS2TJ822T	1/4W 8.2K	2		R925	ERDS2FJ102	1/4W 1K	1	
R237, 38	ERDS2TJ123T	1/4W 12K	2		R926, 27	ERDS2FJ101	1/4W 100	2	
R239-44	ERDS2FJ102	1/4W 1K	6		R928	ERDS2FJ102	1/4W 1K	1	
R331, 32	ERDS2FJ102	1/4W 1K	2		R929	ERDS2FJ101	1/4W 100	1	
R333, 34	ERDS2FJ104	1/4W 100K	2		R930-33	ERDS2FJ102	1/4W 1K	4	
R335, 36	ERDS2FJ562	1/4W 5.6K	2		R934	ERDS2FJ101	1/4W 100	1	
R337, 38	ERDS2TJ123T	1/4W 12K	2		R935	ERDS2FJ102	1/4W 1K	1	
R339, 40	ERDS2TJ471T	1/4W 470	2		R936, 37	ERDS2FJ101	1/4W 100	2	
R341, 42	ERDS2TJ122T	1/4W 1.2K	2		R938	ERDS2FJ102	1/4W 1K	1	
R343, 44	ERDS2FJ224	1/4W 220K	2		R939	ERDS2FJ101	1/4W 100	1	
R345-48	ERDS2FJ103	1/4W 10K	4		R940, 41	ERDS2FJ393	1/4W 39K	2	
R349, 50	ERDS2FJ102	1/4W 1K	2		R942	ERDS2FJ472	1/4W 4.7K	1	
R351	ERDS2TJ182T	1/4W 1.8K	1		R944	ERDS2TJ473T	1/4W 47K	1	
R352	ERDS2FJ102	1/4W 1K	1		R945, 46	ERDS2FJ102	1/4W 1K	2	
R353	ERDS2TJ182T	1/4W 1.8K	1		R947-49	ERDS2FJ103	1/4W 10K	3	
R354, 55	ERDS2FJ222	1/4W 2.2K	2		R950	ERDS2FJ102	1/4W 1K	1	
R356-58	ERDS2TJ391T	1/4W 390	3		R951	ERDS2F104	1/4W 100K	1	
R361, 62	ERDS2TJ223T	1/4W 22K	2		R952, 53	ERDS2FJ102	1/4W 1K	2	
R363, 64	ERDS2FJ102	1/4W 1K	2		R954	ERDS2FJ101	1/4W 100	1	
R365, 66	ERDS2FJ105	1/4W 1M	2		R955	ERDS2TJ824T	1/4W 820K	1	
R372	ERDS2FJ105	1/4W 1M	1		R956	ERDS2FJ101	1/4W 100	1	
R374	ERDS2TJ182T	1/4W 1.8K	1		R957	ERDS2FJ102	1/4W 1K	1	
R375, 76	ERDS2FJ102	1/4W 1K	2		R958	ERDS2TJ471T	1/4W 470	1	
R377, 78	ERDS2TJ121T	1/4W 120	2		R959, 60	ERDS2TJ223T	1/4W 22K	2	
R379, 80	ERDS2TJ223T	1/4W 22K	2		R961	ERDS2FJ103	1/4W 10K	1	
R381	ERDS2FJ105	1/4W 1M	1		R962	ERDS2TJ473T	1/4W 47K	1	
R382	ERDS2FJ472	1/4W 4.7K	1		R963, 64	ERDS2FJ103	1/4W 10K	2	
R383	ERDS2TJ223T	1/4W 22K	1		R965	ERDS2FJ472	1/4W 4.7K	1	
R397, 98	ERQ16NKW2R2E	1/6W 2.2	2		R966	ERDS2TJ223T	1/4W 22K	1	
R501	ERDS2TJ152T	1/4W 1.5K	1		R967	ERDS2FJ472	1/4W 4.7K	1	
R502	ERDS2TJ221T	1/4W 220	1		R968, 69	ERDS2TJ152T	1/4W 1.5K	2	
R506	ERDS2TJ152T	1/4W 1.5K	1		R970	ERDS2TJ473T	1/4W 47K	1	
R507	ERDS2TJ221T	1/4W 220	1		R971	ERDS2FJ104	1/4W 100K	1	
R508, 09	ERDS2TJ223T	1/4W 22K	2		R978-93	ERDS2FJ104	1/4W 100K	16	
R511, 12	ERDS2FJ472	1/4W 4.7K	2		R994	ERDS2FJ102	1/4W 1K	1	
R550	ERDS2FJ472	1/4W 4.7K	1		R997-99	ERDS2FJ102	1/4W 1K	3	
R554	ERDS2FJ102	1/4W 1K	1						
R555	ERDS2TJ333T	1/4W 33K	1		△ RL601	RSY0017M-0	RELAY	1	
R562	ERDS2TJ473T	1/4W 47K	1						
R563	ERDS2TJ332T	1/4W 3.3K	1		S901-10	EVQPTD05Q	SW	10	
R565-67	ERDS2TJ332T	1/4W 3.3K	3						
R568-71	ERDS2FJ101	1/4W 100	4		X101	RSXZ456KM07M	OSCILLATOR	1	
R576	ERDS2FJ102	1/4W 1K	1		X102	RLFDGT05DD	OSCILLATOR	1	
△ R601, 02	ERD2FCJ4R7	1/4W 4.7	2		X103	RSXC7M20SD5T	OSCILLATOR	1	
R603, 04	ERDS2FJ102	1/4W 1K	2		X551	RSXZ456KM07M	OSCILLATOR	1	
R605	ERDS2FJ101	1/4W 100	1		X552	RVBCST4R00MT	OSCILLATOR	1	
R606	ERDS2FJ393	1/4W 39K	1		X901	RSXC4M19S02T	OSCILLATOR	1	
R607	ERDS2TJ153T	1/4W 15K	1						
△ R609	ERQ16NKW2R2E	1/6W 2.2	1		Z101	RLA2Z002M-T	COMPONENT COMBINATION	1	
R610	ERDS2FJ222	1/4W 2.2K	1		Z102	RLI2Z006M-T	COMPONENT COMBINATION	1	
R612	ERDS2FJ472	1/4W 4.7K	1		Z120	RAL0019	FM FRONT END	1	
R613, 14	ERDS2FJ682	1/4W 6.8K	2		Z901	RCDGPIU90XA	REMOTE SENSOR	1	
R615	ERDS2FJ103	1/4W 10K	1						
△ R616	ERDS2FJ4R7	1/4W 4.7	1						
R621, 22	ERDS2TJ151T	1/4W 150	2						

■ Cabinet Parts Location

O.K

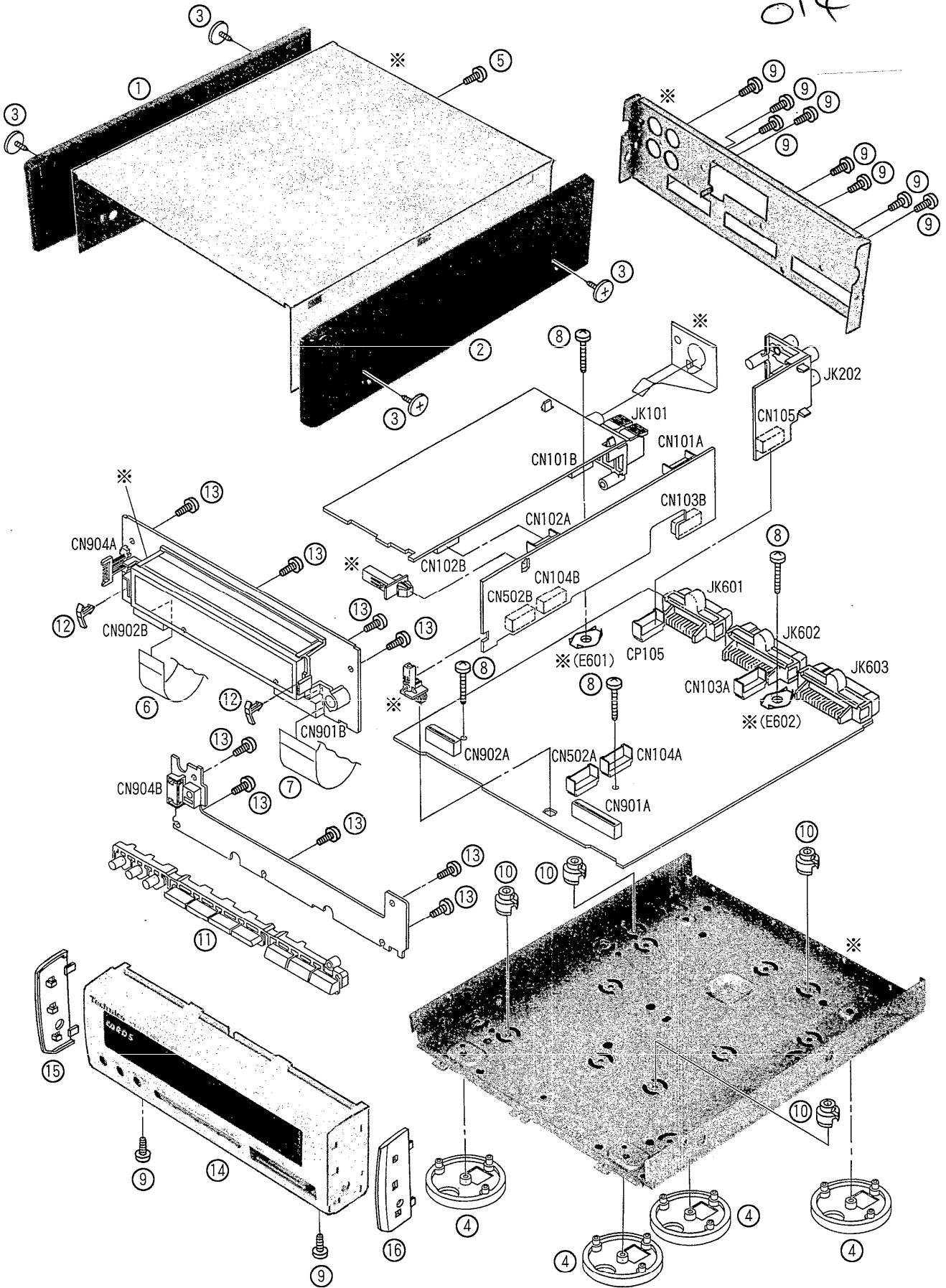

※ : Not supplies.